

Native Plant Society Field Site

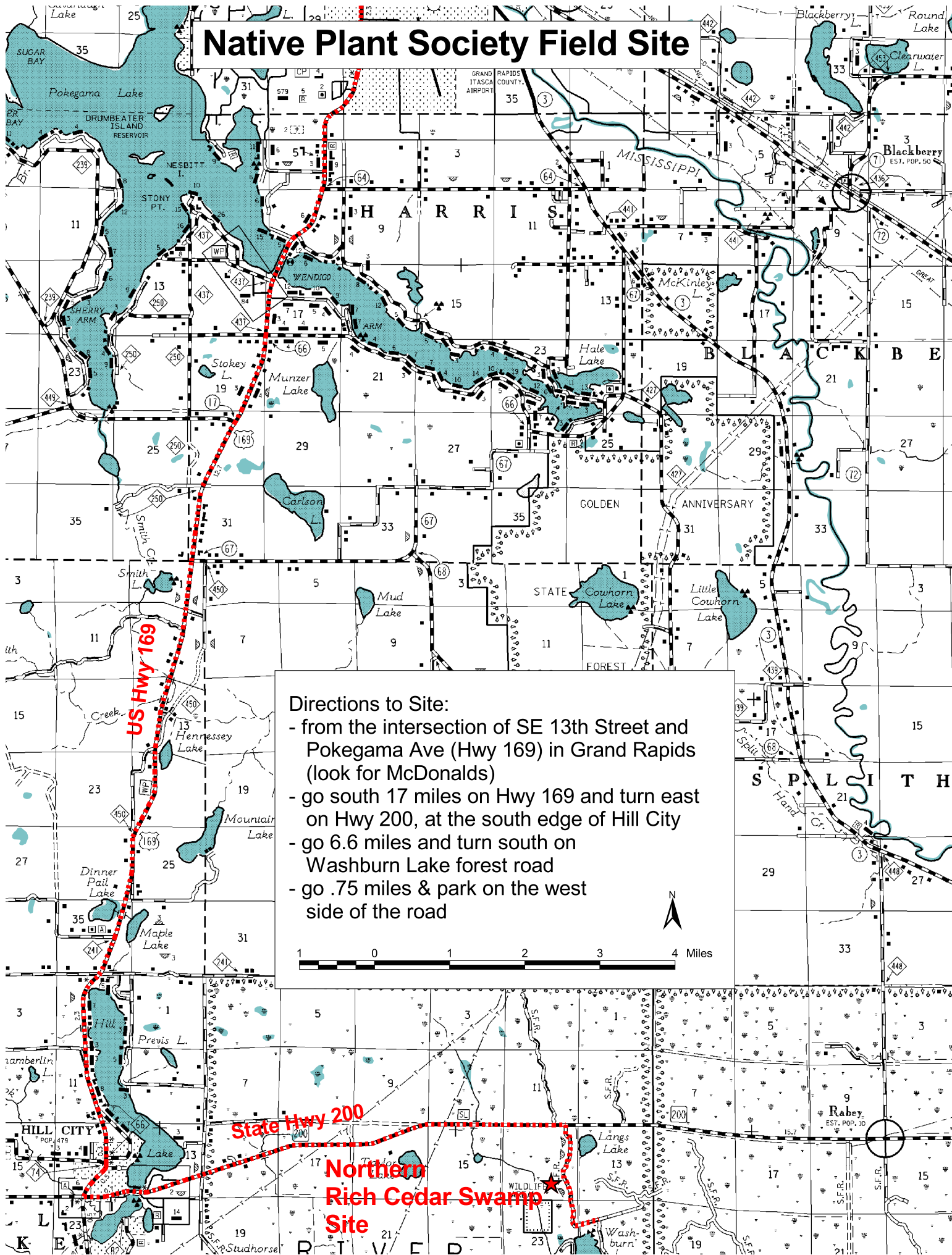

Directions to Site:

- from the intersection of SE 13th Street and Pokegama Ave (Hwy 169) in Grand Rapids (look for McDonalds)
- go south 17 miles on Hwy 169 and turn east on Hwy 200, at the south edge of Hill City
- go 6.6 miles and turn south on Washburn Lake forest road
- go .75 miles & park on the west side of the road



Northern Rich Cedar Swamp Site